







Axe mitoyen supposé

-  Lot 0 = 325,14 m<sup>2</sup>(surf. brute tot) et 267,63 m<sup>2</sup> (surf. nette tot)
-  Parties communes
-  Parties communes à jouissance exclusive au Lot 0
-  Surface accessoire
-  Surface principale
-  Surface de service
-  Surface résiduelle

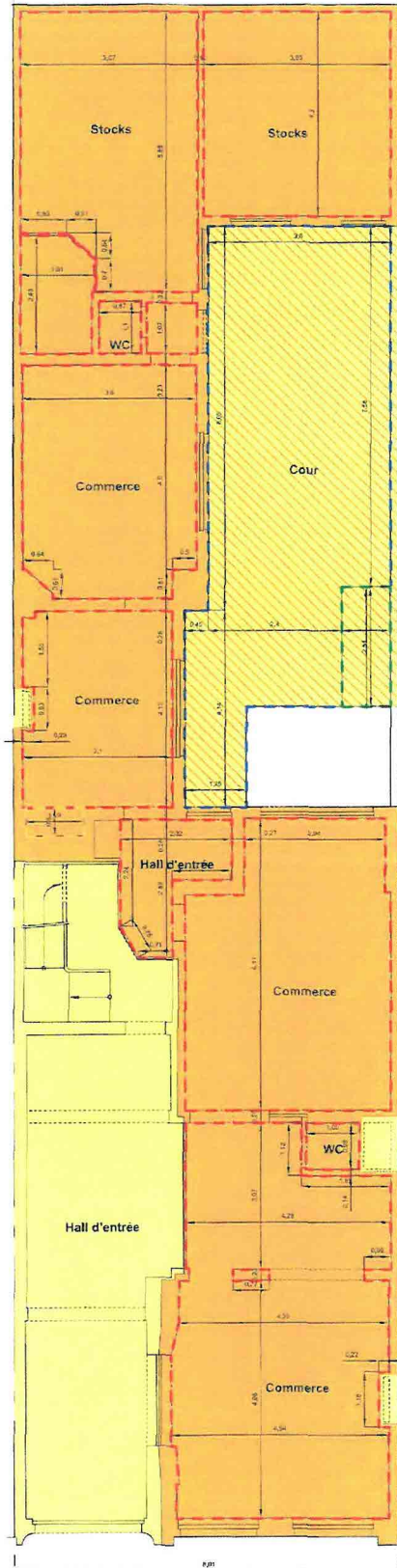

*Handwritten signature*

*Handwritten signature*

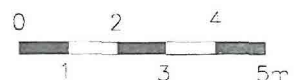
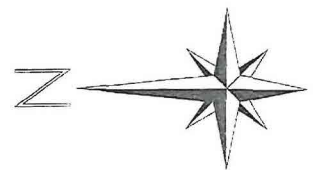

Date: 13/01/2016	COMMUNE DE NAMUR 1 <sup>ère</sup> Division / Section C / n°89 13 Rue des Carmes, 44		Bureau WOLF rue Vanderkindere, 467 - B1180 Bruxelles Tél: 02/346.67.99 fax: 02/344.59.95 Gsm: 0475/85.91.59 email: info@bureauwolf.be	
Echelle: 1/100 (A3)	Ref dossier 15.82	Niveau: Rez-de-Chaussée	Dess.: PAL	

Axe mitoyen supposé

- Cave 1 = 4,39 m<sup>2</sup>(surf. brute tot) et 3,72 m<sup>2</sup> (surf. nette tot)
- Cave 2 = 7,45 m<sup>2</sup>(surf. brute tot) et 6,38 m<sup>2</sup> (surf. nette tot)
- Cave 3 = 11,24 m<sup>2</sup>(surf. brute tot) et 9,03 m<sup>2</sup> (surf. nette tot)
- Lot 0 = 325,14 m<sup>2</sup>(surf. brute tot) et 267,63 m<sup>2</sup> (surf. nette tot)
- Parties communes
- Parties communes à jouissance exclusive au Lot 0
- Surface accessoire
- Surface principale
- Surface de service
- Surface résicuelle

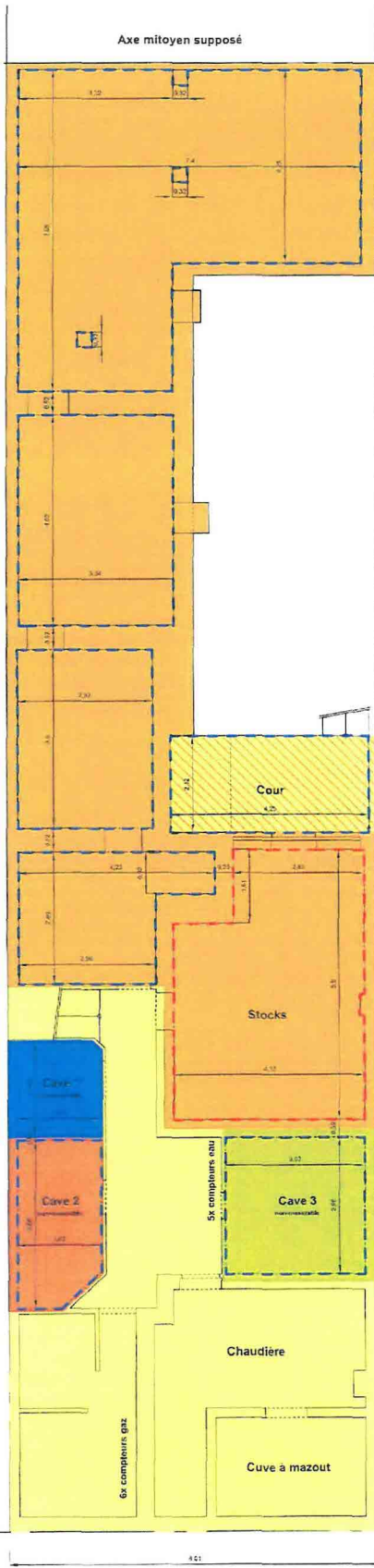

*Handwritten signature and initials*

*Handwritten signature*

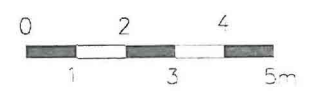
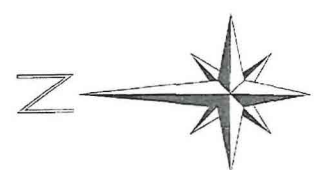

Date: 13/01/2016	<b>COMMUNE DE NAMUR</b> 1 <sup>ème</sup> Division / Section C / n°89 t3 Rue des Carmes, 44			<b>Bureau WOLF</b> rue Vanderkindere, 467 - B1180 Bruxelles Tél: 02/345.67.99 fax: 02/344.59.95 Gsm: 0475/85.91.59 email: info@bureauwolf.be
Echelle: 1/100 (A3)	Ref dossier 15.82	Niveau: Sous-sol	Dess.: PAL	

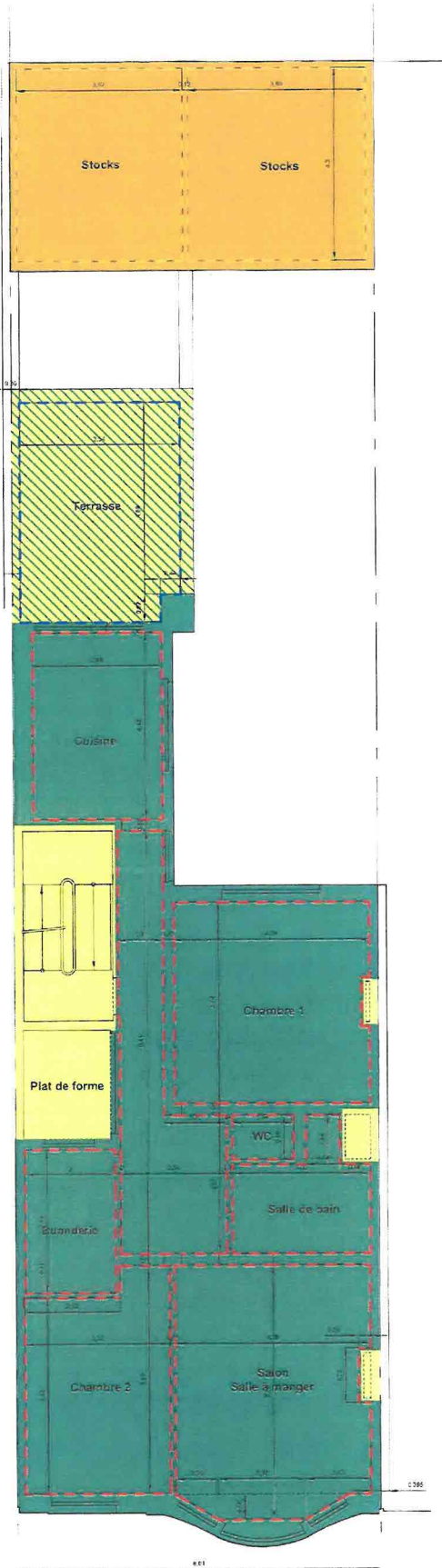

- Lot 0 = 325,14 m<sup>2</sup>(surf. brute tot) et 267,63 m<sup>2</sup> (surf. nette tot)
- Lot 1 = 117,87 m<sup>2</sup>(surf. brute tot) et 96,83 m<sup>2</sup> (surf. nette tot)
- Parties communes à jouissance exclusive au Lot 1
- Surface accessoire
- Surface principale
- Surface de service
- Surface résiduelle

*Handwritten initials in blue ink.*

*Handwritten signature in blue ink.*

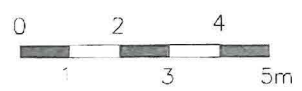
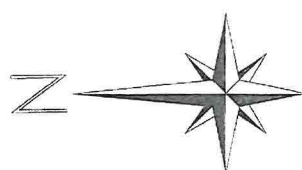

<b>Date:</b> 13/01/2016	<b>COMMUNE DE NAMUR</b> 1 <sup>ère</sup> Division / Section C / n°89 t3 Rue des Carmes, 44		<b>Bureau WOLF</b> rue Vanderkindere, 467 - B1180 Bruxelles Tél: 02/346.67.99 fax: 02/344.59.95 Gsm: 0475/85.91.59 email: info@bureauwolf.be	
<b>Echelle:</b> 1/100 (A3)	<b>Ref dossier:</b> 15.82	<b>Niveau:</b> Premier étage	<b>Dess.:</b> PAL	